



TERMS OF REFERENCE

SUPPLY, DELIVERY AND INSTALLATION OF GLASS PARTITION AND SLIDING DOOR FOR THE PLANNING AND WATER RESOURCES LABORATORY

1. Scope

- a. The scope of work shall be to supply, deliver and install glass partition and sliding door intended for the PWR Laboratory.

2. Site Location

- a. The work shall be done at the CKWD Administrative Building, Blk 01, Casa Subdivision, Brgy. Zone III, Koronadal City South Cotabato.

3. Conditions

- a. Bid price must be inclusive of delivery, tax and other charges.
b. The supplier/contractor must provide the labor and equipment/s needed for the job.
c. The materials that to be incorporated to work shall be of approved and standard quality based on the plans and specifications provided.
d. Safety precautions must be observed upon installation and any accident that may occur upon installation shall be the responsibility of the supplier/contractor.
e. The supplier/contractor shall deliver the supply and services within thirty (30) days after signing the Purchase Order (PO).
f. Payment shall be made after the work is done.

A. Technical Specifications

See attached Plan and Specification.

B. Additional Requirements

1. Must submit a valid Business Permit and/or any proof of facility within Koronadal City, South Cotabato.
(Compliance upon submission of quotation)

Prepared by:

ENGR. MICHELLE A. JUADIONG
Engineering Assistant B

Checked and verified by:

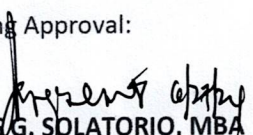

JOSE AMORMIO T. REYES
Division Manager B- GSD

Recommending Approval:

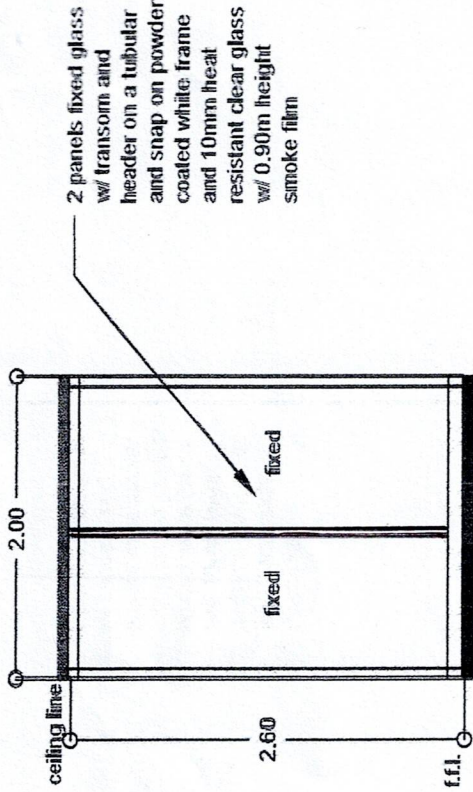
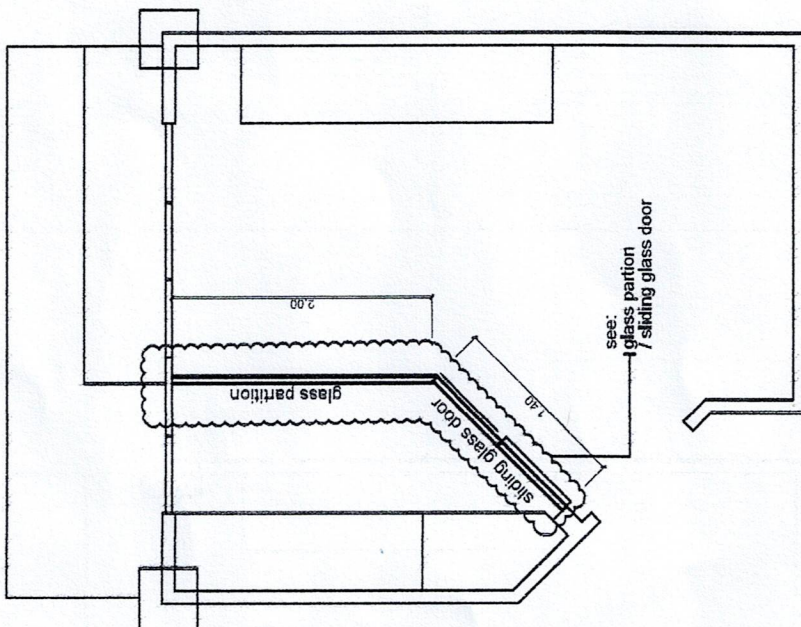

MA. LOURDES G. SOLATORIO, MBA
Department Manager B- AGSD

Approved by:

ATTY. BENJIE G. ESPINOSA
General Manager B

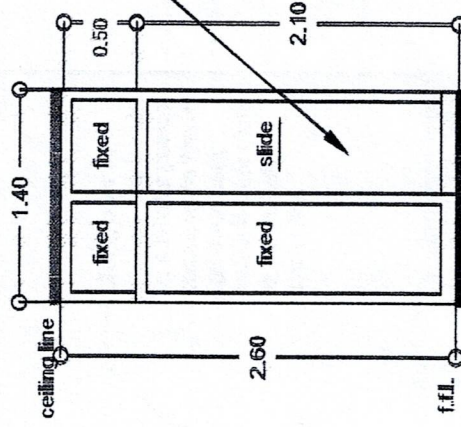

2 panels fixed glass w/ transom and header on a tubular and snap on powder coated white frame and 10mm heat resistant clear glass w/ 0.90m height smoke film



Sliding door w/ transom and header on a tubular powder coated white frame and 6mm heat resistant clear glass w/ 0.90m height smoke film

GLASS PARTITION DETAILS

NTS

SCALE:

Note: All units are in meters



PROJECT TITLE:

PROPOSED PLANNING AND WATER RESOURCES LABORATORY

LOCATION:

CKWD ADMINISTRATIVE BUILDING, BLK 01 CASA SUBDIVISION, ERGY ZONE III, KORONADAL CITY

PREPARED BY:

ENGR. MICHELLE A. JUADIONG
ENGR'S ASSISTANT-B

CHECKED AND VERIFIED BY:

JOSE ANORMO T. REYES
DIVISION MANAGER-B
GSD

DESIGNER/OWNER APPROVAL:

MA. LOURDES G. SOLATORO, MBA
DEPARTMENT MANAGER-B
ACSD

APPROVED:

ATTY. BEATRICE ESPINOSA
GENERAL MANAGER-B

CONFIRMED:

ENGR. MARICELLE T. DUMALAY
CIP-CONTRIBUTOR
PAIR

SHEET NO.:

4

12